

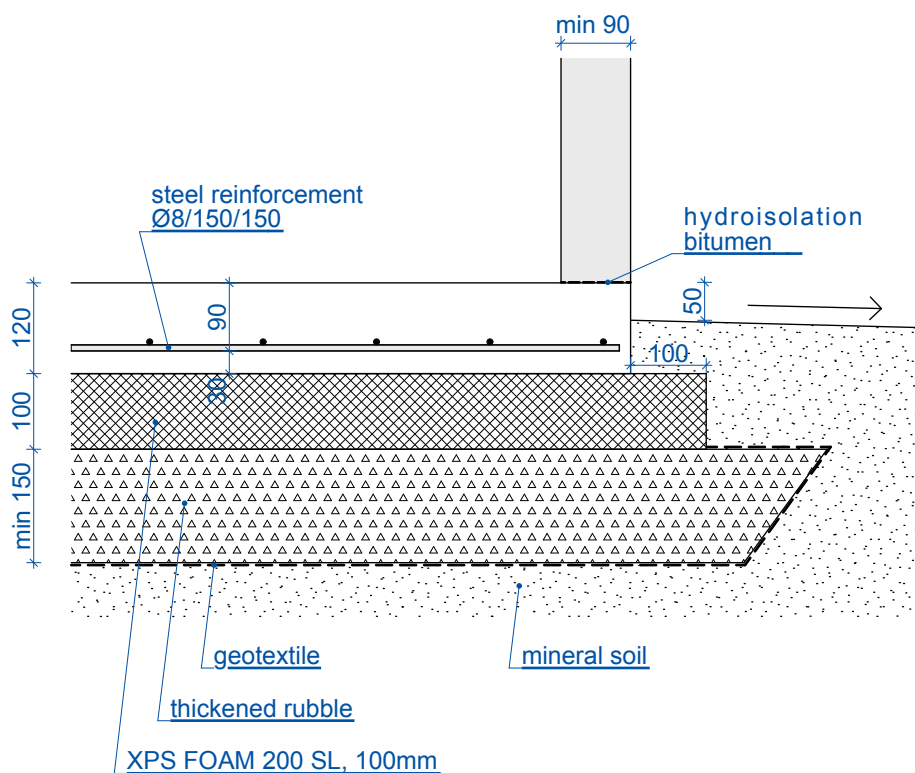

Foundation plan M 1:50



Foundation section M 1:10

Notes:

1. Foundation concrete plate type C25/30, environmental class XC2.
2. Reinforcing bars are weldable rib bars, yield strength $f_{yk}=400\ldots600$ MPa.
3. Thickened rubble thickness factor 0,95.

 LAHE PRODUCTION OÜ	work Greenhouse Lähe <small>Contact: Lahe Production OÜ, phone +372 5207896, e-mail hello@lahehouse.com Solutions have been developed by Lahe Production OÜ This document is intellectual property of Lahe Production OÜ, unauthorized use and copying is prohibited!</small>	stadium TP
		work nr. 012021
architect Maret Rosenberg engineer Peep Rosenberg	owner Lahe Production OÜ	version 12.02.2021
	drawing Lähe N05 Plate foundation plan and section cut	scale 1:10, 1:50 drawing nr. EK-5-02

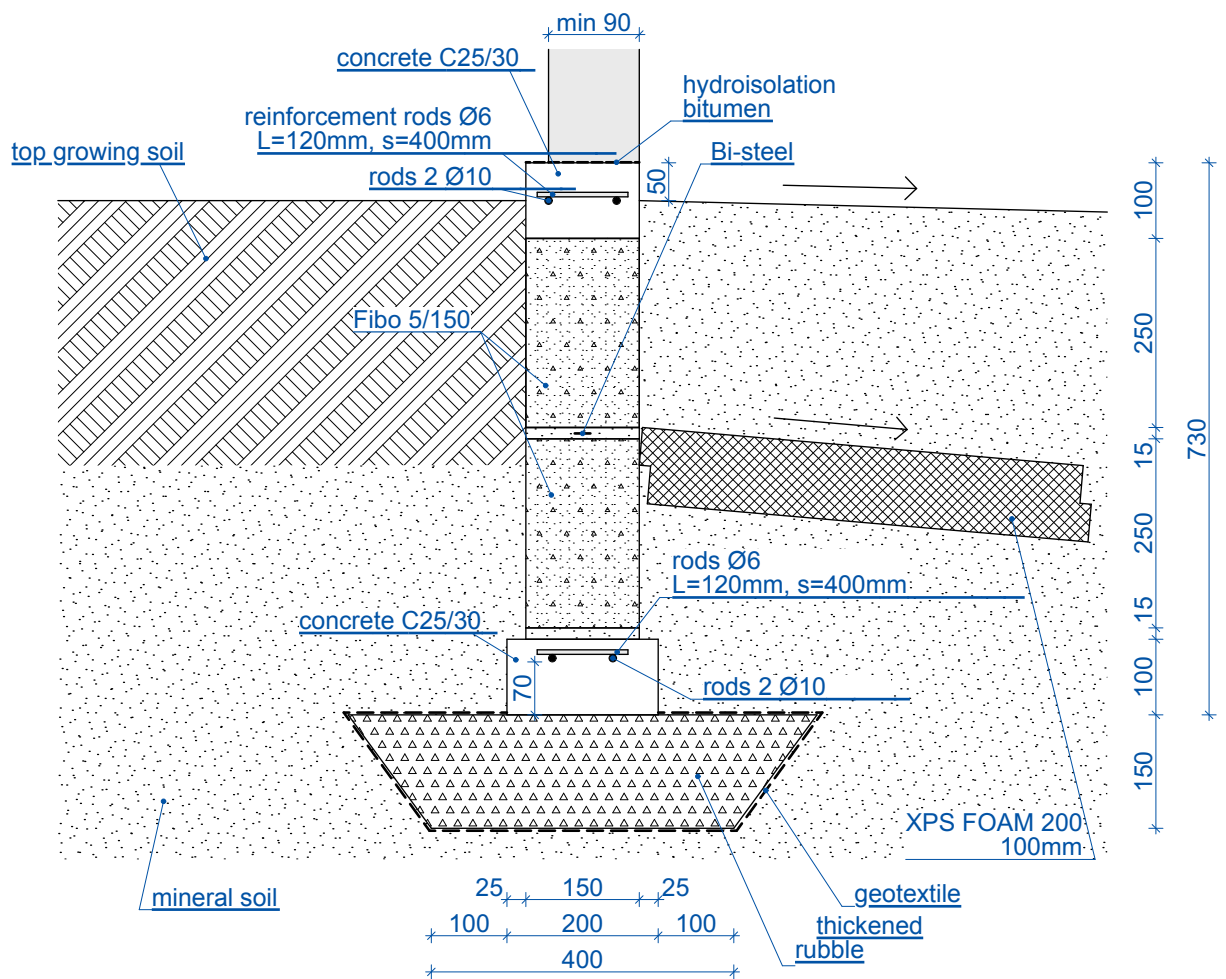
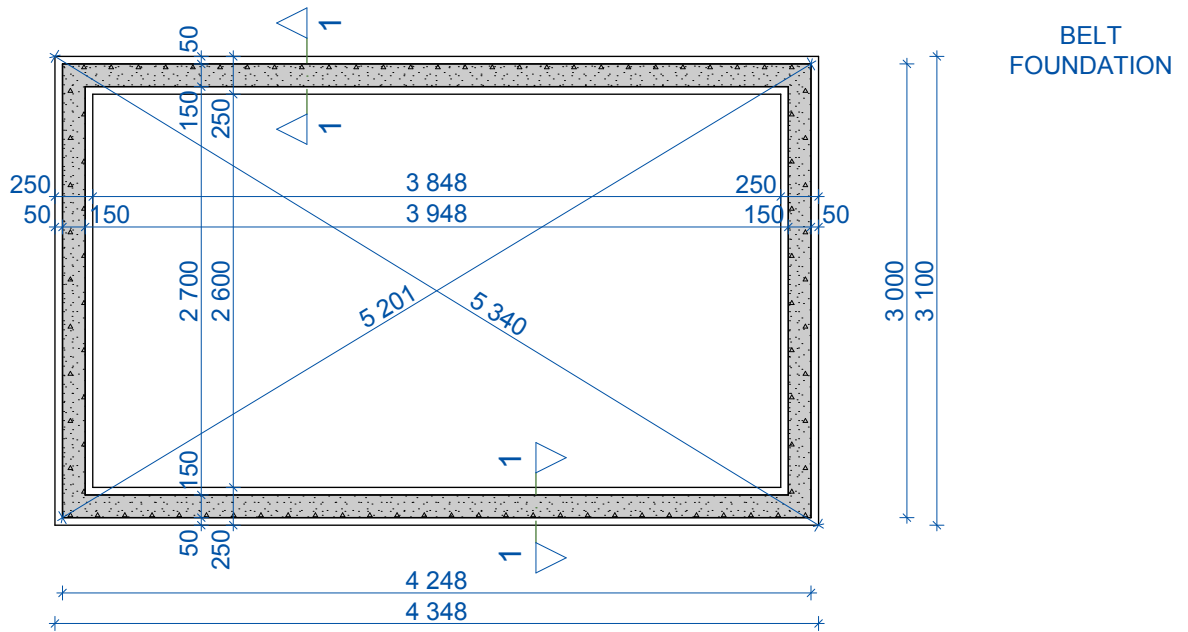

Notes:

1. Foundation concrete plate type C25/30, environmental class XC2.
2. Reinforcing rods are weldable rib rods, yield strength $f_{yk}=400\ldots600$ MPa.
3. Thickened rubble thickness factor 0,95.
4. Lay bricks with full horizontal and vertical joints, mortar paste compression strength min 20 MPa.
5. Bi-steel fully inside brick mortar
6. When laying blocks, use a wall mixture with normal compressive strength 8MPa.
7. In case of high groundwater, solve the foundation with the drainage system.

 LAHE PRODUCTION OÜ	work Greenhouse Lähe Contact: Lahe Production OÜ, phone +372 5207896, e-mail hello@lahehouse.com Solutions have been developed by Lahe Production OÜ. This document is intellectual property of Lahe Production OÜ, unauthorized use and copying is prohibited!	stadium TP
		work nr. 012021
architect Maret Rosenberg engineer Peep Rosenberg	owner Lahe Production OÜ drawing Lähe N05 Belt foundation plan and section cut	version 12.02.2021
		scale 1:50, 1:10 drawing nr. EK-5-06

STONE WALL

